

EXHIBITOR PROSPECTUS

WWW.ASCE.ORG/CONFERENCES/IATC07/

29th INTERNATIONAL AIR TRANSPORT CONFERENCE A WORLD OF GROWTH

SHERATON GRAND HOTEL, IRVING TEXAS
AUGUST 19 - 22, 2007



EXHIBITOR INFORMATION

A World of Growth— Aviation is changing, and with change come new challenges for airports and aviation systems worldwide to keep pace. Airlines in the United States have repositioned themselves to respond to new low-fare competition, new security requirements and the rising cost of jet fuel as they attempt to return to profitability. Meanwhile, air travel has been introduced to the masses in places like China, India, Brazil and Mexico. The low-fare model, introduced in the United States and copied successfully in Europe, is now being discovered in places like Latin America, Asia and Australia. Passenger growth has accelerated since the dark days after September 11, 2001, and massive new airport construction programs are underway to accommodate that growth – in countries as diverse as China, India, The Gulf States and the United States.

As the passenger volume increases, airports struggle to keep up with new aircraft – at both ends of the spectrum. Airports gear up for the arrival of the Airbus A380 – and

for the dramatic increase in travel on 50-70-seat regional jets. Scheduled air service has arrived at airports that never expected to see a passenger jet – from Frankfurt Hahn to Orlando Sanford.

Mexico is planning an upgrade of five airports to serve Mexico City, India talks about 400 new airports and the Gulf region will be served by more and larger airports in the United Arab Emirates, Saudi Arabia and Qatar. Managing growth and developing and financing the infrastructure to accommodate it are the challenges of federal and state agencies, airport administrators, engineers and planners, program management teams, university researchers and consultants alike. The **29th International Air Transportation Conference** provides a forum to address the planning and engineering of airports to meet the challenges of increased demand, larger aircraft and new security requirements. These topics and more will be explored as the Transportation and Development Institute of ASCE hosts the Conference in August, 2007, in the Dallas-Fort Worth Metroplex.

SCHEDULE *subject to change*

Sunday, August 19, 2007

Move in 12:00pm - 4:00pm
Ice Breaker Reception 5:30pm - 7:30pm

Monday August 20, 2007

Exhibit Hall Hours 10:00am - 3:30pm

Tuesday, August 21, 2007

Exhibit Hall Hours 10:00am - 1:00pm
Breakdown 1:00pm - 4:00pm

EXHIBITOR BENEFITS

Booth rentals include one (1) 6-foot skirted table, chair, trash can and ID sign, in addition to the following benefits:

- One (1) full registration, which permits access to all conference sessions and functions
- One (1) exhibit hall registration, which grants access to only the exhibit hall and the functions herein
- Face time with qualified buyers
- A post-conference attendees list
- Exposure at the welcome reception and during all breaks.
- Complimentary food and beverages during the breaks
- Recognition in the technical program
- A heightened profile in the aviation community

TO RESERVE SPACE

Complete the original space application on the next page. A deposit of at least 50% of the total space rental must accompany the application. **The balance is due by July 8, 2007.** Applications received **after July 8, 2007** must be accompanied by full payment. Booths will not be assigned without full payment. **The cost of a single 10' x 10' booth is \$1,750.**

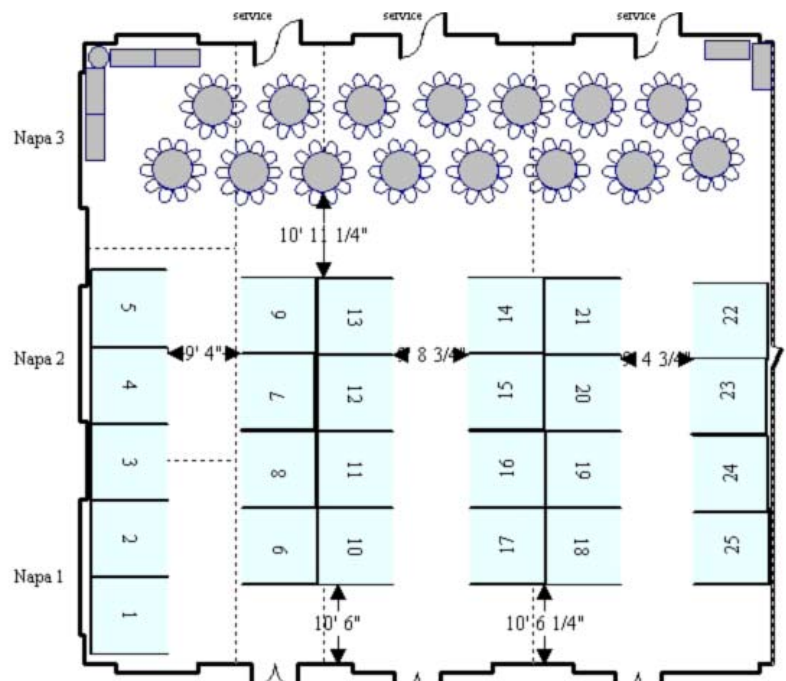

EXHIBIT SPACE CONTRACT

American Society of Civil Engineers - IATC 2007 Conference
Sheraton Grand Hotel ■ August 19-22, 2007

RETURN SIGNED CONTRACT AND PAYMENT TO

ASCE, Attn: Registrar P.O. Box 79668, Baltimore, MD 21279-0668, USA
Phone: (703) 295-6154 Fax: (703) 295-6144

1. Information For Show Program

Complete Company Name as it will appear in Final Program _____

Parent Company or Official Company Name _____

Street Address _____

City, State, Zip _____

Telephone () _____ Fax () _____

Email _____

Correspondence should be sent to _____

Street Address _____

City, State, Zip _____

Telephone () _____ Fax () _____

Email _____

Booth preference

1. _____ 4. _____

2. _____ 5. _____

3. _____ 6. _____

2. Payment Information

Credit Card Number _____ Expiration Date _____

Card Holder's Name _____

Signature of Cardholder _____

3. Payment Policy

Contracts must be accompanied by partially refundable deposit equal to 50% of the total rent for each booth requested. The balance is due **July 8, 2007**. Applications received after **July 8, 2007** must be accompanied by full payment.

4. Rules & Regulations

It is understood that this document will become a binding Contract upon acceptance by ASCE and incorporated into this contract are the terms, conditions, rules and regulations contained herein. Please retain a copy of this contract for your records. Your signature is acceptance of the Rules & Regulations as indicated on the back of this contract and within the Prospectus. The application will be returned if it is not properly signed. Space will not be assigned until the contract is executed properly and/or the appropriate payment is received. The signer agrees to accept the space assigned and can reject it within 10 days of the date of confirmation.

Authorized Applicant Signature, Title _____ Date _____

ASCE Representative _____ Date _____

FOR ASCE USE ONLY: Booth (s) Assigned _____ Date Assigned _____

CODES & AGREEMENTS

WWW.ASCE.ORG/CONFERENCES/IATC07/

CANCELLATION:

The Exhibitor specifically recognizes and agrees that ASCE will sustain losses in the event the Exhibitor fails to provide timely written notice of cancellation (by certified mail). In keeping with industry practice, the existence of such practice being hereby acknowledged by the Exhibitor, and because such losses cannot be precisely measured but include the costs associated with the inability to replace those canceling, advertising, credibility, redesigning of floor space, and the like, the Exhibitor agrees upon the following late cancellation assessment schedule as being in the nature of liquidated damages, which schedule is specifically designed to compensate ASCE for its losses and not constitute a penalty, should the Exhibitor fail to provide timely written notice, by certified mail, of cancellation of all or any part of its assigned booth space.

CANCELLATION DURING THE PERIOD OF:

ASSESSMENT

90 days (Three months) or more prior to event start date	0%
60 to 30 days (two to one months) prior to event start date	50%
Less than 30 days (Four weeks) prior to event start date	100%

Cancellations will be accepted only in accordance with the above schedule. There will be no refunds for cancellations received less than 30 days prior to event start date, and failure to make full payment of deposit on exhibit space rental fee 120 days prior to event start date on a Contract filed prior to, or on, that date will subject Exhibitor to Cancellation of Contract by ASCE, forfeiture of deposit made and liability for balance due. If booth space is not occupied by 4:00 pm on the day before the event start date ASCE shall have the right to use the space. Reletting by ASCE of an Exhibitor's canceled space shall not act to excuse Exhibitor from assessment.

EXHIBIT HOURS:

Exhibit hours, subject to change by ASCE, are published in the preliminary program and final program.

SPACE:

The exhibit space diagram shows the floor arrangement of space. Dimensions and location of each booth are believed to be accurate but only warranted to be approximate.

ARRANGEMENT OF EXHIBITS:

One six-foot table, one chair, one wastepaper basket, and one vendor ID sign are provided without charge. All other furnishings, equipment, facilities, etc., will be provided by Exhibitor at its own expense and responsibility. Display materials may be placed up to a height not exceeding eight feet from the building floor. In any portion of the booth beyond mid-point from the rear background of the booth, all parts of the exhibit shall be paced not to exceed the height of four feet. Exhibits not conforming to these specifications or which in design, operation, or otherwise, are objectionable in the opinion of the management will be prohibited. All demonstrations and exhibits must be confined to the exhibit areas. No exhibitor shall assign, sublet, or share the whole or any part of the booth space allotted.

GENERAL RESTRICTIONS:

Exhibitors are prohibited from using amplifying equipment that is objectionable to ASCE. ■ Exhibitors must confine their activities to their contracted space. ■ Exhibitors will not be permitted to use strolling entertainment or to distribute samples or souvenirs except from their own exhibit area. ■ Exhibitors who use costumed models or mannequins should be sure that their manner of appearance and dress is such as to not offend even the most critical. ■ Draping materials and other decorative materials must be flameproof and comply with all State and local regulations. ■ ASCE reserve the right to require modification of questionable exhibits. ■ "Cash and Carry" sales are not permitted from the exhibit floor. ■ Exhibitors using music in their exhibit area, either live or mechanical, must provide ASCE with a copy of Exhibitors licensing agreement with ASCAP, BMI, SESAC or other such licensing organization or must expressly warrant in writing to ASCE that no such license is required due to exemption under 17 U.S.C. § 110 (5) or other specified exemption. Further, should Exhibitor play music, Exhibitor agrees to indemnify and hold ASCE harmless from any action brought against ASCE by ASCAP, BMI, SESAC or other licensing organization for the playing of such music. ■ Exhibitors are prohibited from serving alcoholic beverages or any other food and beverages without written approval from ASCE. ■ Exhibitors must comply with all safety provisions and other rules and regulations as noted and as required by the Facility and Fire Marshall. ■ The laws of the Commonwealth of Virginia shall govern the construction, interpretation and enforcement of this agreement.

LIABILITIES:

The Exhibitor agrees that ASCE, its agents, and employees, and the Facility or ASCE employees: (a) Will not be responsible for any damage to or for the loss or destruction of the Exhibitor's property or injuries to the Exhibitor, his representatives, agents or employees, all claims for any such loss, damage, destruction, or injury being expressly waived by the Exhibitor, (b) Will be exempted from or indemnified for any claims for injury to any of the Exhibitor's representatives, agents, or employees. The Exhibitor is required to provide a certificate of insurance to ASCE. Exhibitor shall also indemnify and save and hold harmless ASCE and Facility from and against any cost, expense, liability, or damage which may be incident to, arise out of, or be caused by an act, omission, negligence or misconduct on the part of Exhibitor or its agents, servants, employees, contractors, guests, licensees or invitees, provided such damage or injury has not occurred due to the gross negligence of ASCE or Facility. Such indemnification shall not be limited to insurance required herein. ASCE, its agents and employees and ASCE will not be liable for failure to hold the Exhibits as scheduled. Payments for booth space will be returned in that event except that any actual expense incurred in the connection with the Exhibits will be deducted if the Exhibits are called off because of fire, or any act of God, or the public enemy, or strike, or terrorism, or war declared or undeclared, or epidemic, or any law or regulation of public authority or any other act beyond the control of ASCE, which makes it impossible or impracticable to hold the Exhibition.

INSURANCE:

Exhibitors shall insure their own exhibits and display materials. Exhibitors shall carry Public Liability Insurance with a \$1,000,000.00 combined single limit or bodily injury, accident, and property damage. Exhibitor shall obtain a waiver of subrogation, releasing the carrier's subrogation rights, from any insurance carrier that carries fire, explosion or any other risk coverage insuring their property. ASCE will not provide security guard service for this meeting. ASCE is not responsible for loss or theft of any kind.

AMERICANS WITH DISABILITIES ACT:

Exhibitors acknowledge their responsibilities under the Americans with Disabilities Act (hereinafter "Act") to make their booths accessible to handicapped persons. Exhibitor shall also indemnify and hold harmless ASCE and Facility against cost, expense, liability or damage, which may be incident to, arise out of or be caused by Exhibitor's failure to have their exhibit area comply with requirements under the Act.

HANDLING AND STORAGE:

The Facility will not accept or store exhibit materials or empty crates. The Exhibitor will make his own arrangements for delivery and receipt of shipments and storage of crates before move-in time. Fire regulations prohibit the storage of empty crates and cartons within the exhibitor's booth area.

BOOTH FURNITURE, LABOR, AND DRAYAGE:

Orders for utility services may have advance order deadline requirements that must be adhered to by exhibitors in order to ensure installation prior to show opening.

ADMISSIONS:

All persons visiting the exhibits will be admitted according to the rules and regulations of the Exhibits as issued or amended by the authorized representative of ASCE.

RULES AND REGULATIONS:

Exhibitors will abide by all other provisions of these rules and regulations, and with fire regulations and all other regulations of governmental agencies and the Facility. It is expressly understood and agreed by applicant that the Rules and Regulations of the Exhibit as issued or amended by ASCE are hereby made an integral part of the Contract and of the agreement between Applicant and ASCE for this reference and to the same extent and effect as if said Rules and Regulations were set forth in full in the contract.

UNION RESTRICTIONS:

Exhibitors agree to abide by all local jurisdiction union requirements, if applicable, for work involving installation and dismantling of exhibit space.

